

**vtech**<sup>®</sup>  
baby

Instruction Manual

# On-the-Go Animal Arch



**VTech understands that a child's needs and abilities change as they grow and with that in mind we develop our toys to teach and entertain at just the right level...**

## **vtech** Baby

**Toys that will stimulate their interest in different textures, sounds and colours**

### **I am...**

...responding to colours, sounds and textures

...understanding cause and effect

...learning to touch, reach, grasp, sit-up, crawl and toddle

*Birth-36 months*



## **Pre-School**

**Interactive toys to develop their imagination and encourage language development**

### **I want...**

...to get ready for school by starting to learn the alphabet and counting

...my learning to be as fun, easy and exciting as can be

...to show my creativity with drawing and music so my whole brain develops

*3-6 years*



## **Electronic Learning Computers**

**Cool, aspirational and inspiring computers for curriculum related learning**

### **I need...**

...challenging activities that can keep pace with my growing mind

...intelligent technology that adapts to my level of learning

...National Curriculum based content to support what I'm learning at school

*4-10 years*



To learn more about this and other VTech® products, visit [www.vtech.co.uk](http://www.vtech.co.uk)

# INTRODUCTION

Introducing the **On-the-Go Animal Arch** by VTech®!

This cute and playful activity arch has 3 fun safari characters with twisting beads and crinkly textures, enhancing tactile stimulation. Lion's self-discovery mirror and circle ring trigger fun responses and encourage continuous play. The light up heart button triggers fun responses and enjoyable music.

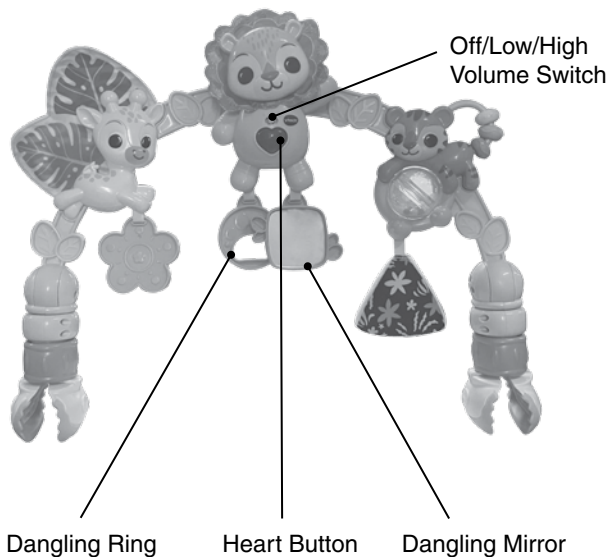

# INCLUDED IN THE PACKAGE

- On-the-Go Animal Arch
- Electronic Module
- Clamps
- Quick Start Guide

## WARNING

All packing materials such as tape, plastic sheets, packaging locks, removable tags, cable ties, cords and packaging screws are not part of this toy and should be discarded for your child's safety.

## NOTE

Please save this Instruction Manual as it contains important information.

### Removing the Packaging Locks:

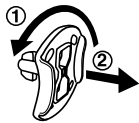

- ① Rotate the packaging lock 90 degrees anticlockwise.

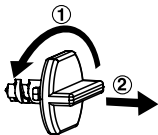

- ② Pull out the packaging lock and discard.

# INSTRUCTIONS

## Battery Removal and Installation

1. Make sure the unit is turned **OFF**.
2. Locate the battery cover on the electronic module inside the back of the lion. Use a screwdriver to loosen the screw and then open the battery cover.
3. Remove old batteries by pulling up on one end of each battery.
4. Install 2 new AAA (AM-4/LR03) batteries following the diagram inside the battery box. (The use of new alkaline batteries is recommended for maximum performance).
5. Replace the battery cover and tighten the screw to secure.

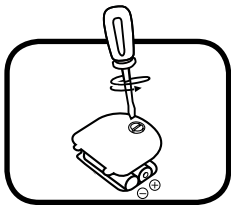

### **WARNING:**

Adult assembly required for battery installation.  
Keep batteries out of reach of children.

### **IMPORTANT: BATTERY INFORMATION**

- Insert batteries with the correct polarity (+ and -).
- Do not mix old and new batteries.
- Do not mix alkaline, standard (carbon-zinc) or rechargeable batteries.
- Only batteries of the same or equivalent type as recommended are to be used.
- Do not short-circuit the supply terminals.
- Remove batteries during long periods of non-use.
- Remove exhausted batteries from the toy.
- Dispose of batteries safely. Do not dispose of batteries in fire.

## RECHARGEABLE BATTERIES:

- Remove rechargeable batteries from the toy before charging.
- Rechargeable batteries are only to be charged under adult supervision.
- Do not charge non-rechargeable batteries.

## Disposal of batteries and product



The crossed-out wheellie bin symbols on products and batteries, or on their respective packaging, indicates they must not be disposed of in domestic waste as they contain substances that can be damaging to the environment and human health.

The chemical symbols Hg, Cd or Pb, where marked, indicate that the battery contains more than the specified value of mercury (Hg), cadmium (Cd) or lead (Pb) set out in the Batteries and Accumulators Regulation.



The solid bar indicates that the product was placed on the market after 13th August, 2005.

Help protect the environment by disposing of your product or batteries responsibly.

## **VTech® cares for the planet.**

Care for the environment and give your toy a second life by disposing of it at a small electricals collection point so all its materials can be recycled.

### **In the UK:**

Visit [www.recyclenow.com](http://www.recyclenow.com) to see a list of collection points near you.

### **In Australia & New Zealand:**

Check with your local council for kerbside collections.

# ASSEMBLY INSTRUCTIONS

With the **On-the-Go Animal Arch**, safety comes first. To ensure your child's safety, adult assembly is required.

## Electronic Module

1. To attach the **Electronic Module** to the **Arch**, please align the block on the middle of the **Arch** with the slot on the back of the **Electronic Module**. Push the block inside the slot. You will hear it click into place when the **Electronic Module** is attached correctly. Please note that once the **Electronic Module** is attached, it cannot be detached.

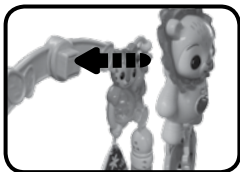

## Clamps

1. The clamps fix the **Arch** onto a pram or pushchair. To attach the clamps onto the **Arch**, please ensure you place the clamps straight upwards to the bottom of the **Arch** ends.
2. To remove the clamps from the **Arch**, press and hold the buttons, then pull the clamps down.

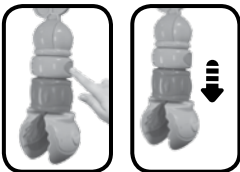
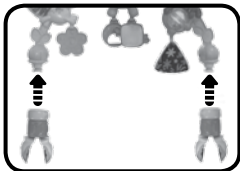

## How to attach the clamps to the pram or pushchair

1. The clamps and the pram or pushchair should align by Changing the direction of the clamps with one hand holding the arch ends and the other hand twisting the clamps.

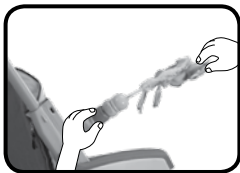

2. Turn the orange ring to open the clamps, attaching them to the pram or pushchair

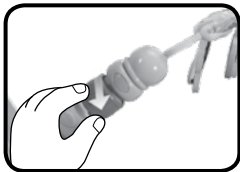

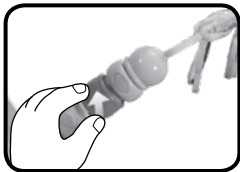

3. Tighten up the ring in the opposite direction, then the clamps will be fixed.





# PRODUCT FEATURES

## 1. Off/Low/High Volume Switch

To turn the unit **ON**, slide the **Off/Low/High Volume Switch** to the **Low Volume**  or **High Volume**  position. You will hear a song and a phrase. To turn the unit **OFF**, slide the **Off/Low/High Volume Switch** to the **OFF**  position.

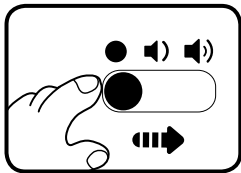

## 2. Automatic Shut Off

To preserve battery life, the **On-the-Go Animal Arch** will automatically power-down after approximately 50 seconds without input. The unit can be turned on again by pressing any button.

### NOTE:

If the unit powers down or the light fades out during play, we suggest changing the batteries.

# ACTIVITIES

## 1. Heart Button

Press the **Heart Button** to learn about colours, animals and hear fun melodies. The light pattern will flash with the sounds.



## 2. Dangling Mirror

Pull the **Dangling Mirror** to hear playful songs and short tunes. The light pattern will flash with the sounds.

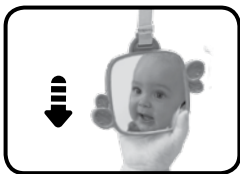

## 3. Dangling Ring

Pull the **Dangling Ring** to hear playful songs and short tunes. The light pattern will flash with the sounds.



## 4. Arch Angle

Adjust the arch angle for easy play.



# MELODY LIST

1. Aiken Drum
2. Ants Go Marching
3. A-Tisket A-Tasket
4. Bicycle Built for Two
5. Bingo
6. The Entertainer
7. Girls and Boys Come Out to Play
8. Hey Diddle Diddle
9. Hot Cross Buns
10. Humpty Dumpty
11. Looby Loo
12. Old MacDonald
13. Pat-A-Cake
14. Skip to My Lou
15. Teddy Bears' Picnic
16. Toyland
17. Wheels on the Bus
18. Yankee Doodle
19. Row, Row, Row Your Boat
20. Oats, Peas, Beans, and Barley Grow

# SONG LYRICS

## Song 1

I'm a lion, a friendly little lion.  
I'm a lion, I want to play with you.

## Song 2

Tiger has stripes,  
Giraffe has spots,  
I am the lion with the big red mane!

## Song 3

Look in the mirror, who do you see?  
I see my little friend looking back at me!

## Song 4

Pull, pull, pull the ring,  
Pull it towards you,  
One, two, three, pull and pull,  
Pull it towards you.

## CARE & MAINTENANCE

1. Keep the unit clean by wiping it with a slightly damp cloth.
2. Keep the unit out of direct sunlight and away from any direct heat sources.
3. Remove the batteries if the unit will not be in use for an extended period of time.
4. Do not drop the unit on hard surfaces and do not expose the unit to moisture or water.

## TROUBLESHOOTING

If for some reason the program/activity stops working or malfunctions, please follow these steps:

1. Please turn the unit **OFF**.
2. Interrupt the power supply by removing the batteries.
3. Let the unit stand for a few minutes, then replace the batteries.
4. Turn the unit **ON**. The unit should now be ready to play with again.
5. If the product still does not work, install a brand new set of batteries.

If the problem persists, please contact our Consumer Services Department and a service representative will be happy to help you

# CONSUMER SERVICES

Creating and developing **VTech**<sup>®</sup> products is accompanied by a responsibility that we at **VTech**<sup>®</sup> take very seriously. We make every effort to ensure the accuracy of the information, which forms the value of our products. However, errors sometimes can occur. It is important for you to know that we stand behind our products and encourage you to call our Consumer Services Department with any problems and/or suggestions that you might have. A service representative will be happy to help you.

## **UK Customers:**

Phone: 0330 678 0149 (from UK) or +44 330 678 0149 (outside UK)  
Website: [www.vtech.co.uk/support](http://www.vtech.co.uk/support)

## **Australian Customers:**

Phone: 1800 862 155  
Website: [support.vtech.com.au](http://support.vtech.com.au)

## **NZ Customers:**

Phone: 0800 400 785  
Website: [support.vtech.com.au](http://support.vtech.com.au)

# PRODUCT WARRANTY/ CONSUMER GUARANTEES

## **UK Customers:**

Read our complete warranty policy online at [vtech.co.uk/warranty](http://vtech.co.uk/warranty).

## **Australian Customers:**

VTECH ELECTRONICS (AUSTRALIA) PTY LIMITED –  
CONSUMER GUARANTEES

Under the Australian Consumer Law, a number of consumer guarantees apply to goods and services supplied by VTech Electronics (Australia) Pty Limited. Please refer to [vtech.com.au/consumerguarantees](http://vtech.com.au/consumerguarantees) for further information.

**Visit our website for more  
information about our products,  
downloads, resources and more.**

***www.vtech.co.uk***  
***www.vtech.com.au***

